

**Weyburn Property**

**Township 6, Range 13 W2**

Located just off the northeastern edge of the Weyburn Unit, this property includes six wells, a facility with a disposal well and ~720 acres of PNG rights.

The Midale Marly and Vuggy beds have both been targeted here, with productivity dependent on reservoir development and structure. Further drilling opportunities exist where horizontal wells can be placed to maximize exposure to both reservoirs, particularly with multiple legs. A strong, northeast to southwest-trending structural nose is present and warrants further exploration.

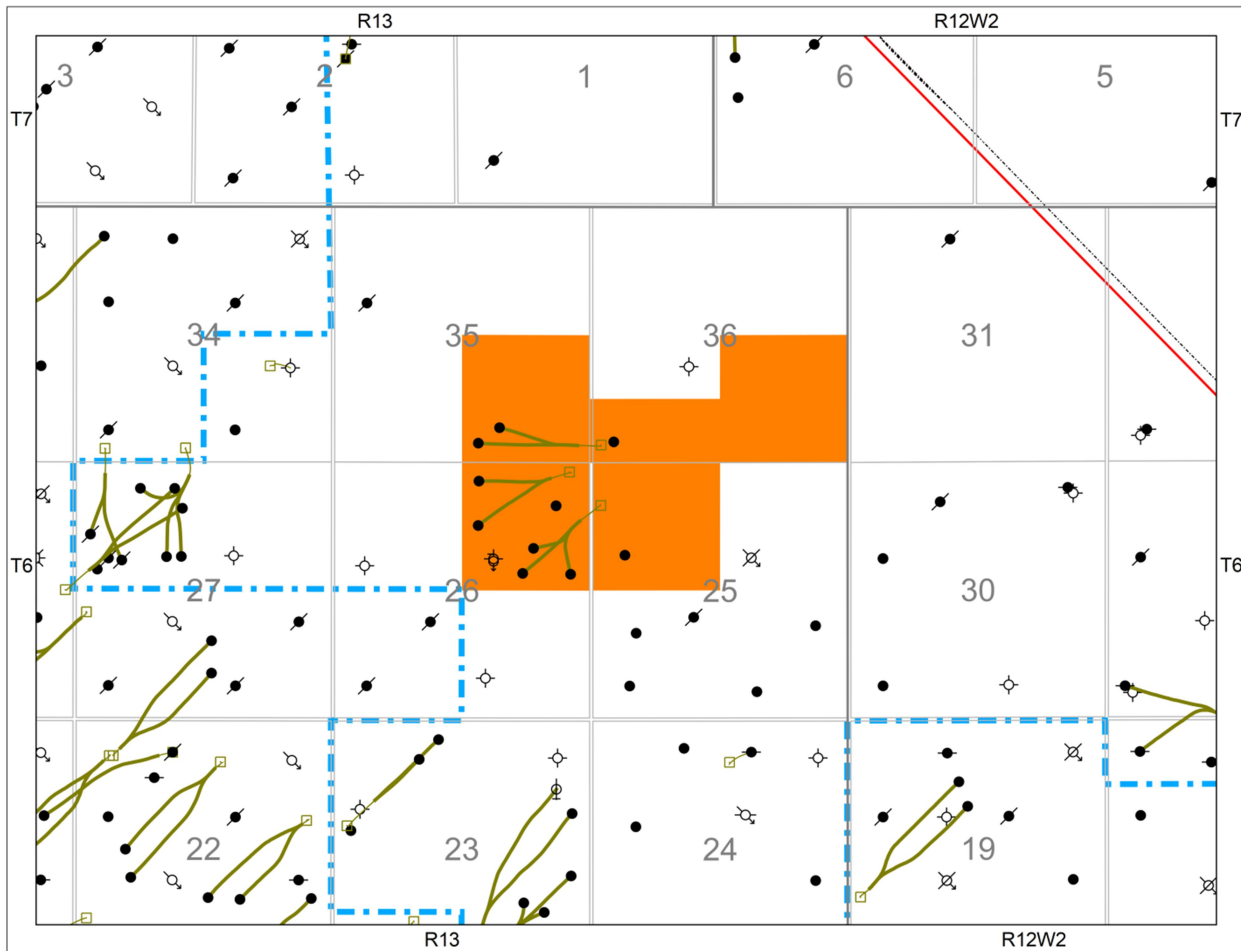

Figure 1: The Weyburn property is highlighted orange and the edge of the Weyburn Unit is delineated by the blue dashed line.

Weyburn			
Lands	WI	Net Acreage	# of Producing Wells
6-13 W2; NW 25	87.5%	160	1
6-13 W2; NE 26	100%	160	3
6-13 W2; SE 35	100%	160	1
6-13 W2; SE, 3 & 4 of 36	100%	240	1